

# RUNWAY S DALI

“When designing Runway, we took a holistic approach, starting from the effect of lighting by creating a family of both linear lighting - creating general light and spotlights - creating accent lighting. Tying it all together with the golden DALI portions, curvatures and connectivity. Design worthy the attention of a fashion runway.”

LED-spotlight with passive cooling system.  
Dimmable by DALI  
Die cast aluminium body, powder coat painted.  
Integral heatsink. Premium in-track driver.  
Low ripple output current <4% to assure camera and scanner friendly performance.  
Rotation 355°. Vertical adjustment +/- 90°.  
Track mounted with GAC Pulse driver-adapter.



<b>Class of DALItection</b>	IP20, class I
<b>Colours</b>	White, black
<b>Weight total</b>	700g
<b>Reflector</b>	High purity MIRO segmented
<b>Lifetime LED</b>	100 000h L90/B50 at Ta 25°C
<b>Driver h/max failure</b>	50 000h/10% at Ta 25°C
<b>Mounting</b>	Driver-adapter for Pulse track
<b>Voltage</b>	220-240V 50/60hz
<b>Qty/MCB 16A type B</b>	Max 60pcs (19W) - 36pcs (32W)
<b>Ripple out. current</b>	< 4%. Flicker-free performance
<b>Colour consistency</b>	2 SDCM
<b>Photobiological safety</b>	RG1
<b>Design</b>	Jesper Ståhl
<b>Dimming 100-1%</b>	DALI

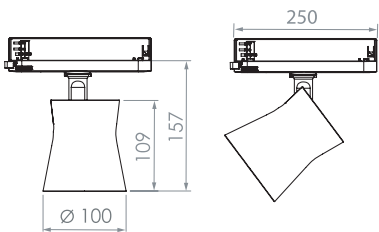

- White
- Black

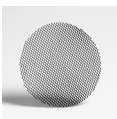

## Accessories

Honeycomb louvre **225091**

# RUNWAY S DALI



Description	Reflector	CCT (K)	CRI	Lumen	Load	Lumen	Lm/W	○ White	● Black																																																																																																
LIGHTSOURCE					LUMINAIRE			ART. No.																																																																																																	
WARM WHITE 3000K [930]																																																																																																									
RUNWAY S DALI 2000lm SP 930	Spot 15°	3000K	92	2320	16W	2180	136	225510	225514																																																																																																
RUNWAY S DALI 2000lm ME 930	Medium 25°	3000K	92	2320	16W	2180	136	225511	225515																																																																																																
RUNWAY S DALI 2000lm FL 930	Flood 40°	3000K	92	2320	16W	2180	136	225512	225516																																																																																																
RUNWAY S DALI 2000lm WFL 930	Widefl. 60°	3000K	92	2320	16W	2180	136	225513	225517																																																																																																
RUNWAY S DALI 3500lm SP 930	Spot 15°	3000K	92	4040	28W	3790	136	225610	225614																																																																																																
RUNWAY S DALI 3500lm ME 930	Medium 25°	3000K	92	4040	28W	3790	136	225611	225615																																																																																																
RUNWAY S DALI 3500lm FL 930	Flood 40°	3000K	92	4040	28W	3790	136	225612	225616																																																																																																
RUNWAY S DALI 3500lm WFL 930	Widefl. 60°	3000K	92	4040	28W	3790	136	225613	225617																																																																																																
<table><tr><th colspan="4">Spot</th><th colspan="4">Medium</th><th colspan="4">Flood</th><th colspan="4">Wideflood</th></tr><tr><th>m</th><th>Ø</th><th>Lux</th><th>Lux</th><th>m</th><th>Ø</th><th>Lux</th><th>Lux</th><th>m</th><th>Ø</th><th>Lux</th><th>Lux</th><th>m</th><th>Ø</th><th>Lux</th><th>Lux</th></tr><tr><td>1</td><td>0,28</td><td>14169</td><td>25543</td><td>1</td><td>0,42</td><td>7887</td><td>13663</td><td>1</td><td>0,74</td><td>4971</td><td>8611</td><td>1</td><td>1,19</td><td>2404</td><td>4164</td></tr><tr><td>2</td><td>0,56</td><td>3542</td><td>6136</td><td>2</td><td>0,84</td><td>1972</td><td>3416</td><td>2</td><td>1,42</td><td>1243</td><td>2153</td><td>2</td><td>2,38</td><td>601</td><td>1041</td></tr><tr><td>3</td><td>0,84</td><td>1574</td><td>2727</td><td>3</td><td>1,25</td><td>876</td><td>1518</td><td>3</td><td>2,18</td><td>552</td><td>957</td><td>2,5</td><td>2,97</td><td>267</td><td>666</td></tr><tr><td>4</td><td>1,12</td><td>886</td><td>1596</td><td>4</td><td>1,70</td><td>792</td><td>854</td><td>4</td><td>2,91</td><td>311</td><td>538</td><td>3</td><td>3,56</td><td>150</td><td>463</td></tr></table>					Spot				Medium				Flood				Wideflood				m	Ø	Lux	Lux	m	Ø	Lux	Lux	m	Ø	Lux	Lux	m	Ø	Lux	Lux	1	0,28	14169	25543	1	0,42	7887	13663	1	0,74	4971	8611	1	1,19	2404	4164	2	0,56	3542	6136	2	0,84	1972	3416	2	1,42	1243	2153	2	2,38	601	1041	3	0,84	1574	2727	3	1,25	876	1518	3	2,18	552	957	2,5	2,97	267	666	4	1,12	886	1596	4	1,70	792	854	4	2,91	311	538	3	3,56	150	463					
Spot				Medium				Flood				Wideflood																																																																																													
m	Ø	Lux	Lux	m	Ø	Lux	Lux	m	Ø	Lux	Lux	m	Ø	Lux	Lux																																																																																										
1	0,28	14169	25543	1	0,42	7887	13663	1	0,74	4971	8611	1	1,19	2404	4164																																																																																										
2	0,56	3542	6136	2	0,84	1972	3416	2	1,42	1243	2153	2	2,38	601	1041																																																																																										
3	0,84	1574	2727	3	1,25	876	1518	3	2,18	552	957	2,5	2,97	267	666																																																																																										
4	1,12	886	1596	4	1,70	792	854	4	2,91	311	538	3	3,56	150	463																																																																																										
NEUTRAL WHITE 4000K [940]																																																																																																									
RUNWAY S DALI 2000lm SP 940	Spot 15°	4000K	92	2330	16W	2185	137	225550	225554																																																																																																
RUNWAY S DALI 2000lm ME 940	Medium 25°	4000K	92	2330	16W	2185	137	225551	225555																																																																																																
RUNWAY S DALI 2000lm FL 940	Flood 40°	4000K	92	2330	16W	2185	137	225552	225556																																																																																																
RUNWAY S DALI 2000lm WFL 940	Widefl. 60°	4000K	92	2330	16W	2185	137	225553	225557																																																																																																
RUNWAY S DALI 3500lm SP 940	Spot 15°	4000K	92	4140	28W	3890	139	225650	225654																																																																																																
RUNWAY S DALI 3500lm ME 940	Medium 25°	4000K	92	4140	28W	3890	139	225651	225655																																																																																																
RUNWAY S DALI 3500lm FL 940	Flood 40°	4000K	92	4140	28W	3890	139	225652	225656																																																																																																
RUNWAY S DALI 3500lm WFL 940	Widefl. 60°	4000K	92	4140	28W	3890	139	225653	225657																																																																																																
<table><tr><th colspan="4">Spot</th><th colspan="4">Medium</th><th colspan="4">Flood</th><th colspan="4">Wideflood</th></tr><tr><th>m</th><th>Ø</th><th>Lux</th><th>Lux</th><th>m</th><th>Ø</th><th>Lux</th><th>Lux</th><th>m</th><th>Ø</th><th>Lux</th><th>Lux</th><th>m</th><th>Ø</th><th>Lux</th><th>Lux</th></tr><tr><td>1</td><td>0,28</td><td>15545</td><td>25249</td><td>1</td><td>0,42</td><td>8097</td><td>14055</td><td>1</td><td>0,74</td><td>5103</td><td>8859</td><td>1</td><td>1,19</td><td>2468</td><td>4284</td></tr><tr><td>2</td><td>0,56</td><td>3636</td><td>6312</td><td>2</td><td>0,84</td><td>2024</td><td>3514</td><td>2</td><td>1,42</td><td>1276</td><td>2215</td><td>2</td><td>2,38</td><td>617</td><td>1071</td></tr><tr><td>3</td><td>0,84</td><td>1616</td><td>2805</td><td>3</td><td>1,25</td><td>900</td><td>1562</td><td>3</td><td>2,18</td><td>567</td><td>984</td><td>2,5</td><td>2,97</td><td>395</td><td>685</td></tr><tr><td>4</td><td>1,12</td><td>972</td><td>1578</td><td>4</td><td>1,70</td><td>506</td><td>878</td><td>4</td><td>2,91</td><td>319</td><td>554</td><td>3</td><td>3,56</td><td>274</td><td>476</td></tr></table>					Spot				Medium				Flood				Wideflood				m	Ø	Lux	Lux	m	Ø	Lux	Lux	m	Ø	Lux	Lux	m	Ø	Lux	Lux	1	0,28	15545	25249	1	0,42	8097	14055	1	0,74	5103	8859	1	1,19	2468	4284	2	0,56	3636	6312	2	0,84	2024	3514	2	1,42	1276	2215	2	2,38	617	1071	3	0,84	1616	2805	3	1,25	900	1562	3	2,18	567	984	2,5	2,97	395	685	4	1,12	972	1578	4	1,70	506	878	4	2,91	319	554	3	3,56	274	476					
Spot				Medium				Flood				Wideflood																																																																																													
m	Ø	Lux	Lux	m	Ø	Lux	Lux	m	Ø	Lux	Lux	m	Ø	Lux	Lux																																																																																										
1	0,28	15545	25249	1	0,42	8097	14055	1	0,74	5103	8859	1	1,19	2468	4284																																																																																										
2	0,56	3636	6312	2	0,84	2024	3514	2	1,42	1276	2215	2	2,38	617	1071																																																																																										
3	0,84	1616	2805	3	1,25	900	1562	3	2,18	567	984	2,5	2,97	395	685																																																																																										
4	1,12	972	1578	4	1,70	506	878	4	2,91	319	554	3	3,56	274	476																																																																																										
WARM WHITE 2700K [927]																																																																																																									
RUNWAY S DALI 2000lm SP 927	Spot 15°	2700K	92	2235	16W	2105	131	225520	225524																																																																																																
RUNWAY S DALI 2000lm ME 927	Medium 25°	2700K	92	2235	16W	2105	131	225521	225525																																																																																																
RUNWAY S DALI 2000lm FL 927	Flood 40°	2700K	92	2235	16W	2105	131	225522	225526																																																																																																
RUNWAY S DALI 2000lm WFL 927	Widefl. 60°	2700K	92	2235	16W	2105	131	225523	225527																																																																																																
RUNWAY S DALI 3500lm SP 927	Spot 15°	2700K	92	3870	28W	3640	130	225620	225624																																																																																																
RUNWAY S DALI 3500lm ME 927	Medium 25°	2700K	92	3870	28W	3640	130	225621	225625																																																																																																
RUNWAY S DALI 3500lm FL 927	Flood 40°	2700K	92	3870	28W	3640	130	225622	225626																																																																																																
RUNWAY S DALI 3500lm WFL 927	Widefl. 60°	2700K	92	3870	28W	3640	130	225623	225627																																																																																																
<table><tr><th colspan="4">Spot</th><th colspan="4">Medium</th><th colspan="4">Flood</th><th colspan="4">Wideflood</th></tr><tr><th>m</th><th>Ø</th><th>Lux</th><th>Lux</th><th>m</th><th>Ø</th><th>Lux</th><th>Lux</th><th>m</th><th>Ø</th><th>Lux</th><th>Lux</th><th>m</th><th>Ø</th><th>Lux</th><th>Lux</th></tr><tr><td>1</td><td>0,28</td><td>13567</td><td>23591</td><td>1</td><td>0,42</td><td>7552</td><td>13133</td><td>1</td><td>0,74</td><td>4760</td><td>8277</td><td>1</td><td>1,19</td><td>2302</td><td>4002</td></tr><tr><td>2</td><td>0,56</td><td>3392</td><td>5898</td><td>2</td><td>0,84</td><td>1888</td><td>3283</td><td>2</td><td>1,42</td><td>1190</td><td>2069</td><td>2</td><td>2,38</td><td>757</td><td>1001</td></tr><tr><td>3</td><td>0,84</td><td>1507</td><td>2621</td><td>3</td><td>1,25</td><td>839</td><td>1459</td><td>3</td><td>2,18</td><td>529</td><td>920</td><td>2,5</td><td>2,97</td><td>368</td><td>640</td></tr><tr><td>4</td><td>1,12</td><td>848</td><td>1474</td><td>4</td><td>1,70</td><td>472</td><td>821</td><td>4</td><td>2,91</td><td>298</td><td>517</td><td>3</td><td>3,56</td><td>256</td><td>250</td></tr></table>					Spot				Medium				Flood				Wideflood				m	Ø	Lux	Lux	m	Ø	Lux	Lux	m	Ø	Lux	Lux	m	Ø	Lux	Lux	1	0,28	13567	23591	1	0,42	7552	13133	1	0,74	4760	8277	1	1,19	2302	4002	2	0,56	3392	5898	2	0,84	1888	3283	2	1,42	1190	2069	2	2,38	757	1001	3	0,84	1507	2621	3	1,25	839	1459	3	2,18	529	920	2,5	2,97	368	640	4	1,12	848	1474	4	1,70	472	821	4	2,91	298	517	3	3,56	256	250					
Spot				Medium				Flood				Wideflood																																																																																													
m	Ø	Lux	Lux	m	Ø	Lux	Lux	m	Ø	Lux	Lux	m	Ø	Lux	Lux																																																																																										
1	0,28	13567	23591	1	0,42	7552	13133	1	0,74	4760	8277	1	1,19	2302	4002																																																																																										
2	0,56	3392	5898	2	0,84	1888	3283	2	1,42	1190	2069	2	2,38	757	1001																																																																																										
3	0,84	1507	2621	3	1,25	839	1459	3	2,18	529	920	2,5	2,97	368	640																																																																																										
4	1,12	848	1474	4	1,70	472	821	4	2,91	298	517	3	3,56	256	250																																																																																										

Spot		2000lm		3500lm	
m	Ø	Lux	Lux	Lux	Lux
1	0,28	14169	25543		
2	0,56	3542	6136		
3	0,84	1574	2727		
4	1,12	886	1596		

Medium		2000lm		3500lm	
m	Ø	Lux	Lux	Lux	Lux
1	0,42	7887	13663		
2	0,84	1972	3416		
3	1,25	876	1518		
4	1,70	792	854		

Flood		2000lm		3500lm	
m	Ø	Lux	Lux	Lux	Lux
1	0,74	4971	8611		
2	1,42	1243	2153		
3	2,18	552	957		
4	2,91	311	538		

Wideflood		2000lm		3500lm	
m	Ø	Lux	Lux	Lux	Lux
1	1,19	2404	4164		
2	2,38	601	1041		
2,5	2,97	267	666		
3	3,56	150	463		

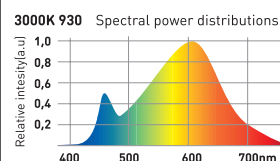

Spot		2000lm		3500lm	
m	Ø	Lux	Lux	Lux	Lux
1	0,28	15545	25249		
2	0,56	3636	6312		
3	0,84	1616	2805		
4	1,12	972	1578		

Medium		2000lm		3500lm	
m	Ø	Lux	Lux	Lux	Lux
1	0,42	8097	14055		
2	0,84	2024	3514		
3	1,25	900	1562		
4	1,70	506	878		

Flood		2000lm		3500lm	
m	Ø	Lux	Lux	Lux	Lux
1	0,74	5103	8859		
2	1,42	1276	2215		
3	2,18	567	984		
4	2,91	319	554		

Wideflood		2000lm		3500lm	
m	Ø	Lux	Lux	Lux	Lux
1	1,19	2468	4284		
2	2,38	617	1071		
2,5	2,97	395	685		
3	3,56	274	476		

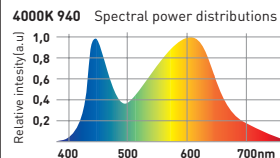

Spot		2000lm		3500lm	
m	Ø	Lux	Lux	Lux	Lux
1	0,28	13567	23591		
2	0,56	3392	5898		
3	0,84	1507	2621		
4	1,12	848	1474		

Medium		2000lm		3500lm	
m	Ø	Lux	Lux	Lux	Lux
1	0,42	7552	13133		
2	0,84	1888	3283		
3	1,25	839	1459		
4	1,70	472	821		

Flood		2000lm		3500lm	
m	Ø	Lux	Lux	Lux	Lux
1	0,74	4760	8277		
2	1,42	1190	2069		
3	2,18	529	920		
4	2,91	298	517		

Wideflood		2000lm		3500lm	
m	Ø	Lux	Lux	Lux	Lux
1	1,19	2302	4002		
2	2,38	757	1001		
2,5	2,97	368	640		
3	3,56	256	250		

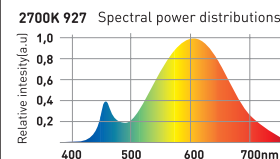

Luminous flux and connected electrical load are subject to an initial tolerance of +/- 5%. Tolerance of colour temperature: +/-150 K. Tolerance of CRI +/- 1,5. Values apply to an ambient temperature of 25°C.

# RUNWAY S DALI Tunable White



Description	Reflector	CCT (K)	CRI	Load	Lumen	○ White	● Black																																																																																																																																																
LIGHTSOURCE				LUMINAIRE		ART. No.																																																																																																																																																	
TUNABLE WHITE 2500-6500K [927-965]																																																																																																																																																							
RUNWAY S DALI 2000TW SP 927-965	Spot 15°	2700-6500K	92	22W	1615-1952	225590	225594																																																																																																																																																
RUNWAY S DALI 2000TW ME 927-965	Medium 25°	2700-6500K	92	22W	1615-1952	225591	225595																																																																																																																																																
RUNWAY S DALI 2000TW FL 927-965	Flood 40°	2700-6500K	92	22W	1615-1952	225592	225596																																																																																																																																																
RUNWAY S DALI 2000TW WFL 927-965	Widefl. 60°	2700-6500K	92	22W	1615-1952	225593	225597																																																																																																																																																
<table><tr><th colspan="2">Spot</th><th colspan="2">2700K</th><th colspan="2">6500K</th></tr><tr><th>m</th><th>Ø</th><th>Lux</th><th>Lux</th><th>Lux</th><th>Lux</th></tr><tr><td>1</td><td>0,28</td><td>10458</td><td>12641</td><td></td><td></td></tr><tr><td>2</td><td>0,56</td><td>2615</td><td>3160</td><td></td><td></td></tr><tr><td>3</td><td>0,84</td><td>1162</td><td>1405</td><td></td><td></td></tr><tr><td>4</td><td>1,12</td><td>654</td><td>790</td><td></td><td></td></tr></table> <table><tr><th colspan="2">Medium</th><th colspan="2">2700K</th><th colspan="2">6500K</th></tr><tr><th>m</th><th>Ø</th><th>Lux</th><th>Lux</th><th>Lux</th><th>Lux</th></tr><tr><td>1</td><td>0,42</td><td>5822</td><td>7037</td><td></td><td></td></tr><tr><td>2</td><td>0,84</td><td>1455</td><td>1759</td><td></td><td></td></tr><tr><td>3</td><td>1,25</td><td>647</td><td>782</td><td></td><td></td></tr><tr><td>4</td><td>1,70</td><td>364</td><td>440</td><td></td><td></td></tr></table> <table><tr><th colspan="2">Flood</th><th colspan="2">2700K</th><th colspan="2">6500K</th></tr><tr><th>m</th><th>Ø</th><th>Lux</th><th>Lux</th><th>Lux</th><th>Lux</th></tr><tr><td>1</td><td>0,74</td><td>3669</td><td>4435</td><td></td><td></td></tr><tr><td>2</td><td>1,42</td><td>917</td><td>1109</td><td></td><td></td></tr><tr><td>3</td><td>2,18</td><td>408</td><td>493</td><td></td><td></td></tr><tr><td>4</td><td>2,91</td><td>229</td><td>277</td><td></td><td></td></tr></table>				Spot		2700K		6500K		m	Ø	Lux	Lux	Lux	Lux	1	0,28	10458	12641			2	0,56	2615	3160			3	0,84	1162	1405			4	1,12	654	790			Medium		2700K		6500K		m	Ø	Lux	Lux	Lux	Lux	1	0,42	5822	7037			2	0,84	1455	1759			3	1,25	647	782			4	1,70	364	440			Flood		2700K		6500K		m	Ø	Lux	Lux	Lux	Lux	1	0,74	3669	4435			2	1,42	917	1109			3	2,18	408	493			4	2,91	229	277			<table><tr><th colspan="2">Wideflood</th><th colspan="2">2700K</th><th colspan="2">6500K</th></tr><tr><th>m</th><th>Ø</th><th>Lux</th><th>Lux</th><th>Lux</th><th>Lux</th></tr><tr><td>1</td><td>1,19</td><td>1774</td><td>2145</td><td></td><td></td></tr><tr><td>2</td><td>2,38</td><td>444</td><td>536</td><td></td><td></td></tr><tr><td>2,5</td><td>2,97</td><td>284</td><td>343</td><td></td><td></td></tr><tr><td>3</td><td>3,56</td><td>197</td><td>238</td><td></td><td></td></tr></table>		Wideflood		2700K		6500K		m	Ø	Lux	Lux	Lux	Lux	1	1,19	1774	2145			2	2,38	444	536			2,5	2,97	284	343			3	3,56	197	238				
Spot		2700K		6500K																																																																																																																																																			
m	Ø	Lux	Lux	Lux	Lux																																																																																																																																																		
1	0,28	10458	12641																																																																																																																																																				
2	0,56	2615	3160																																																																																																																																																				
3	0,84	1162	1405																																																																																																																																																				
4	1,12	654	790																																																																																																																																																				
Medium		2700K		6500K																																																																																																																																																			
m	Ø	Lux	Lux	Lux	Lux																																																																																																																																																		
1	0,42	5822	7037																																																																																																																																																				
2	0,84	1455	1759																																																																																																																																																				
3	1,25	647	782																																																																																																																																																				
4	1,70	364	440																																																																																																																																																				
Flood		2700K		6500K																																																																																																																																																			
m	Ø	Lux	Lux	Lux	Lux																																																																																																																																																		
1	0,74	3669	4435																																																																																																																																																				
2	1,42	917	1109																																																																																																																																																				
3	2,18	408	493																																																																																																																																																				
4	2,91	229	277																																																																																																																																																				
Wideflood		2700K		6500K																																																																																																																																																			
m	Ø	Lux	Lux	Lux	Lux																																																																																																																																																		
1	1,19	1774	2145																																																																																																																																																				
2	2,38	444	536																																																																																																																																																				
2,5	2,97	284	343																																																																																																																																																				
3	3,56	197	238																																																																																																																																																				
CCT	CRI	Load	Lumen																																																																																																																																																				
2700K	92	22W	1615																																																																																																																																																				
3000K	92	22W	1648																																																																																																																																																				
4000K	92	22W	1762																																																																																																																																																				
5000K	92	22W	1837																																																																																																																																																				
6500K	92	22W	1952																																																																																																																																																				

Luminous flux and connected electrical load are subject to an initial tolerance of +/- 5%. Tolerance of colour temperature: +/-150 K. Tolerance of CRI +/- 1,5. Values apply to an ambient temperature of 25°C.

# DALI - Dimming & Control

RUNWAY S DALI is equipped with control adapter for Global Pulse Tracks. Dimmable 100-1% by either DALI or DALI-dimmer.

The DALI lighting control system delivers unparalleled performance, maximum control, flexibility and increased energy savings.

DALI-dimmers offer easy installation and maintenance. Wiring is simple and installation costs are lower.

By adding a converter all DALI-luminaires can be integrated into wireless systems.

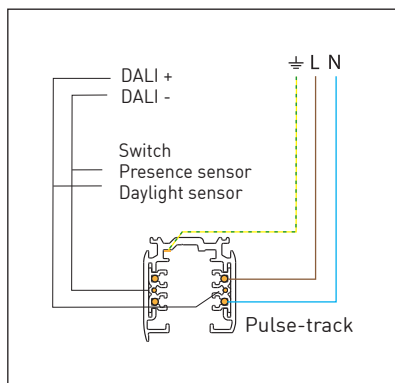

## DALI LIGHTING CONTROL SYSTEM

The DALI lighting control system delivers maximum control, flexibility and increased energy savings.

DALI can control a single light fitting or a defined group of fittings.

Different scenes and lightlevels may be set. The DALI specification allows for a maximum of 64 luminaires per network, which can be broken up to 16 different groups, each with its own lighting scene.

DALI is an industry standard protocol that allows DALI-compliant components from different manufacturers to be mixed and matched together seamlessly into complete systems.

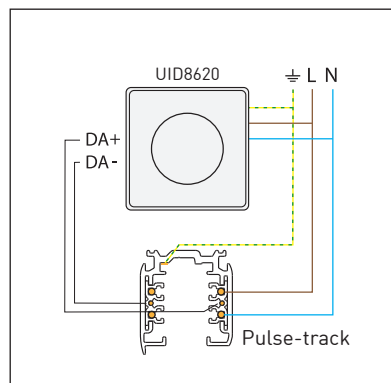
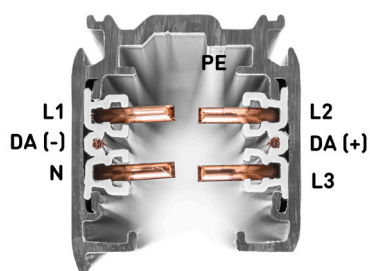

## DALI Dimmer

DALI compliant dimmers offers easy installation. Generally applicable for indoor lighting control with DALI compliant devices. Brightness is controlled in broadcast mode so all connected devices will react simultaneously.

Dimming level 100-1%. Preset levels can be set. Maximum 32 DALI-loads may be connected to one UIB 8620.



## DALI to CASAMBI

DALI luminaires can be converted to Casambi networks with the addition of a Casambi DALI-bridge.

All DALI luminaires and Casambi Ready controllers can be combined together and controlled as a single Casambi mesh network, from the Casambi App.

## Global Pulse

3-circuit 16A mains voltage track system with additional control signals.

Lystra DALI tracklights are equipped with GAC Pulse-adapter and may be controlled via DALI or with DALI-dimmer. (For example Philips UID 8620, Schnedier Exxact DALI or Osram MCU).

